

IAP Interior Absorption Panels

Highly absorptive panels for reverberation control



IAP Interior Absorption Panels are a highly absorptive panels for the primary purpose of reverberation control. Mainly used as wall and ceiling treatment around noisy equipment. Designed for economy and ease of installation.

- Guaranteed to comply with specified performance.
- A modular panel system, available in standard sizes – but can be designed to fit any space.
- 50mm, 75mm or 100mm thick panels.
- Plain galvanised, powder-coated or epoxy paint finishes in a range of colours available.

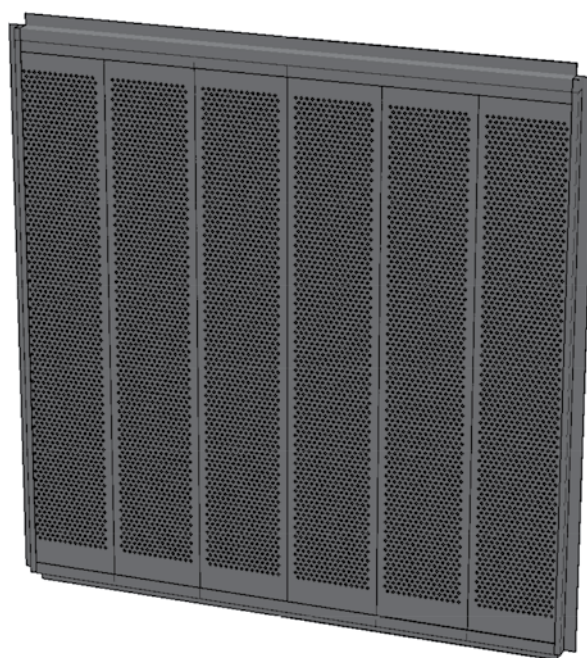

CONSTRUCTION

IAP Interior Absorption Panels are made to order, various sizes and cut-outs can be manufactured. Available in three thickness, 50mm, 75mm or 100mm for greater sound absorption.

Constructed from pre-galvanised steel components with high-density acoustic infill. The infill material is protected behind a flat perforated metal facing. The perforated metal facing has a high open area to maintain acoustic performance.

The acoustic infill has a Group Number of 1-s which complies with New Zealand Building Code clause C3.4(a). Tests were carried out in accordance with NZBC Verification Method C/VM2 Appendix A : Establishing group numbers for lining materials.

Available with a galvanised finish or with a powdercoat paint finish to any of the available powdercoat colours for an attractive high quality finish.

ABSORPTION COEFFICIENT

Model	Octave Band Centre Frequency (Hz)							
	NRC	125	250	500	1k	2k	4k	8k
IAP50	0.93	0.17	0.70	1.00	1.00	1.00	0.95	0.90
IAP75	0.96	0.41	0.85	1.00	1.00	1.00	0.95	0.90
IAP100	1.00	0.65	1.00	1.00	1.00	1.00	0.95	0.90

The figures are random incidence sound absorption as defined by ISO354:2003 Acoustics – Measurement of sound absorption in a reverberation room.

DIMENSIONS & MASS

Model	Standard Dimensions (mm)			Mass (kg/m ²) Excludes framing
	Width	Height	Thickness	
IAP50	450	Up to 2400	50	11
IAP75	400		75	12.5
IAP100	350		100	14

Other sizes available.

Typical Section Through Panelling

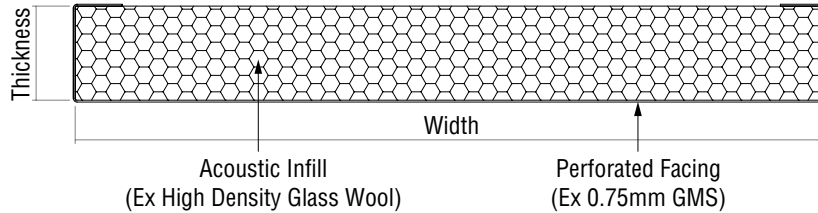

INSTALLATION

Typically installed in a 'pin-up' board style, fixed directly to walls/ceilings or in screens/walls with the NCS framing system – ZED.

Can be combined with other NCS Acoustics products such as Louvres, Acoustic Doors and Windows to create Acoustic Enclosures.

Typical Installation

Six panels used in this example – different sizes and any number of panels can be used to suit building layout.

Panels riveted to top and bottom ZED in corners.
ZED can be cut to suit on site (ex 1.6mm gms).
ZED is fixed to wall via fixings at 600oc.

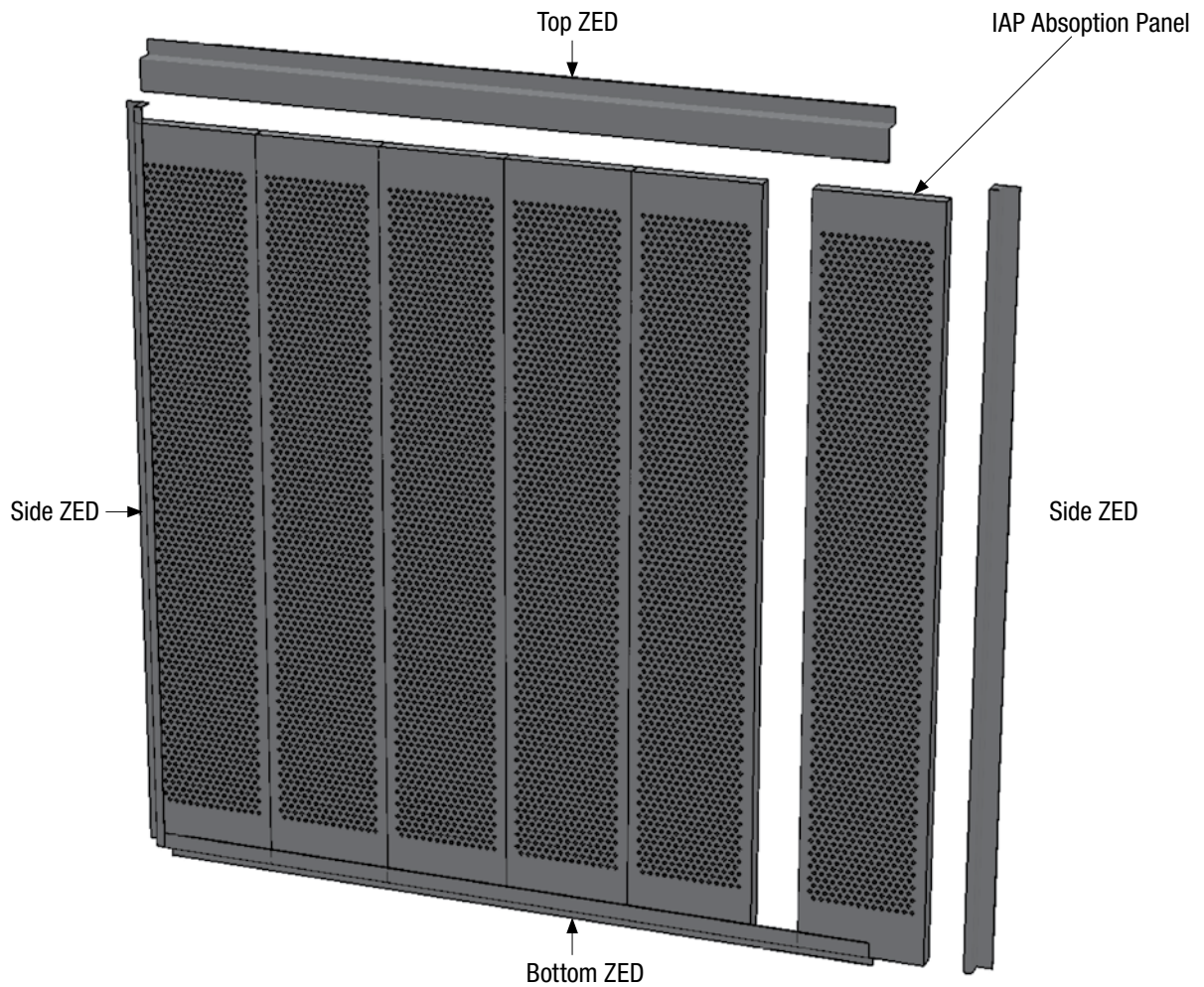

EAP EXTERIOR ABSORPTION PANELS

For exterior reverberation control use EAP Exterior Absorption Panels, with a durable sheet steel skin and self-draining infill. For more information see the EAP Exterior Absorption Panels brochure.

ADDITIONAL INFORMATION

Visit our website or contact us for information on installation, testing, monitoring, maintenance services and technical guides.



Got a question? Call us to discuss
with an experienced engineer:

+64 9 269 0001

Or visit our website for more information:

www.ncsacoustics.co.nz

Data correct at time of publication, please ensure you have the latest version by checking our website. NCS Acoustics Limited accepts no liability for use of data within this brochure. Materials may be updated at any time without notice.